



**Lamello**

## Clamex S-20

Detachable furniture connector for the 4 mm groove

- Open the connection time and time again with the rotating lever
- Use with any biscuit joiner
- Narrow connector allows installation into the edge in materials from 8 mm



**AVAILABLE FROM  
4 SEPTEMBER  
2023**

## Features

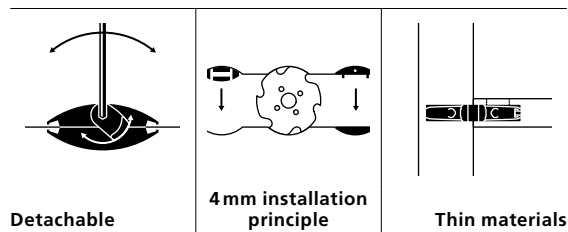

Clamex S-20 is a detachable connector for the Lamello system for material thicknesses from 16 mm and is fastened in the groove with screws.

The symmetric 4 mm grooves can be created with any biscuit joiner.

Clamex S-20 is connected to the counterpart with a lever and has a lateral installation tolerance.

It requires no adhesive, enables aesthetic connections at all angles and is ideal for fixed or detachable connections.

## Processing

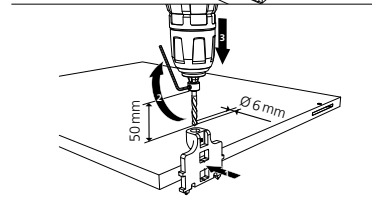
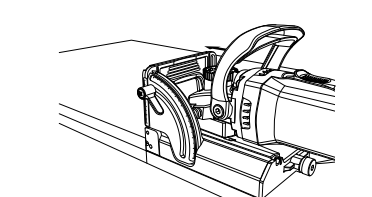
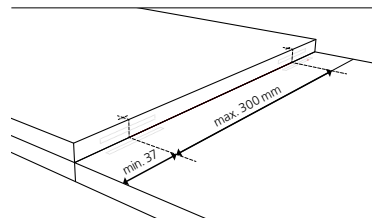
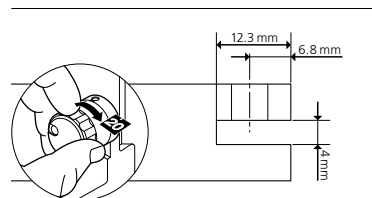

## Connector insertion

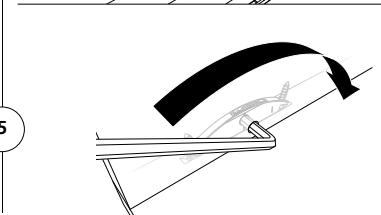
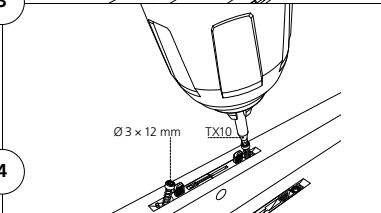
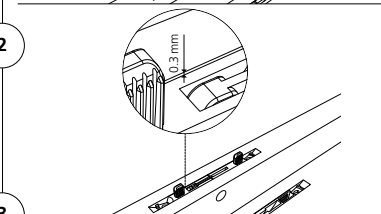
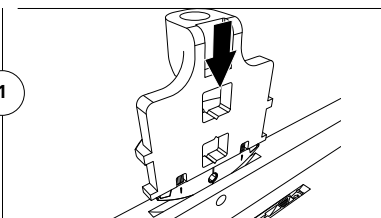

1

2

3

4

5

# Applications

- **Furniture construction/interior fitting:** Wardrobes installed in sloping roofs, cabinets, roof linings, restorations, prototype construction, cabinet manufacturing, sideboards, thin surface connections, shelves and much more.
- **Furniture joints:** Corner connections, surface connections, frame connections and various angles



Articles



<b>Clamex S-20</b>	Art. No.
20 pairs, incl. screws	<b>145243</b>
80 pairs, incl. screws	<b>145244</b>
300 pairs	<b>145245</b>
1000 pairs	<b>145246</b>



<b>Clamex S-20 Starter set</b>	Art. No.
In Systainer <sup>3</sup> M137, scope of delivery:	<b>145247</b>
Clamex S-20, 80 pairs incl. screws,	
Clamex S-20 drill jig inclc. drill Ø 6 mm,	
Clamex P Installation tool	



Technical data

<b>Joining methods</b>	Size	59 × 12 × 3.9 mm		
	Cutter	Ø 100 × 4 × 22 mm		
	Material connector	Fiberglass reinforced plastic		
	Material of lever	Zinc die cast		
	Installation tolerance	Long. ± 1 mm/radial ± 0 mm		
	Tensile strength (N)	MDF	Particle board	Beech
	Up to	620 <sup>1</sup>	490 <sup>1</sup>	620 <sup>1</sup>
Material range		Particle board, MDF, plywood, solid wood, compact laminate, etc.		

